

# 7. Installing the Bin Unit.

Bin instructions and hardware supplied in bin hardware box. Please follow bin instructions carefully.

**Note.** Bin Door front is sold separately. Handles (if required) and handle template also sold separately.

**2** Lift the locking levers and remove the front part of each runner. Ensure shoulder of bracket faces outwards.

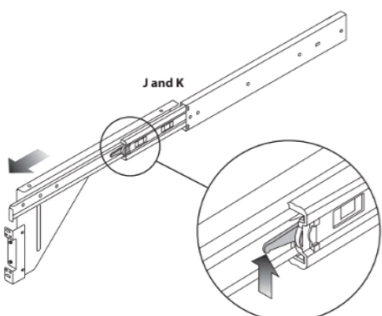

**3** Fit the lid brackets and runners to cabinet sides using screws **A**.

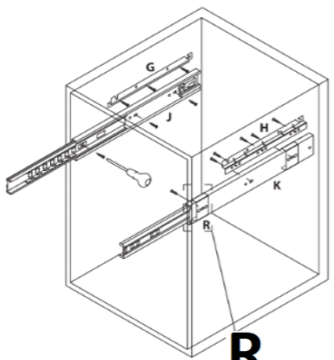

**4** Fit the door brackets to the

*IMPORTANT:* When fitting the brackets to the door careful consideration should be taken to ensure fixing screws do not protrude through the fascia.

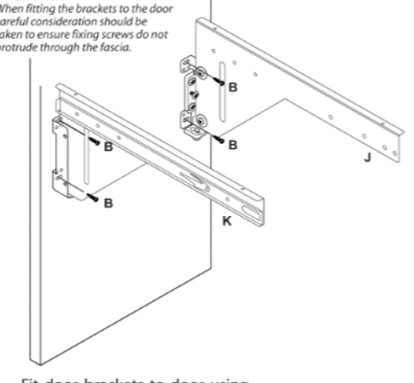

Fit door brackets to door using screws **B**

**5** Assemble each runner until the locking levers are securely attached.

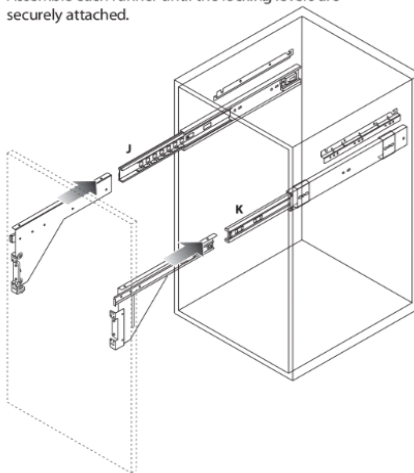

**6** Fit the frame to the runners using screws **C**

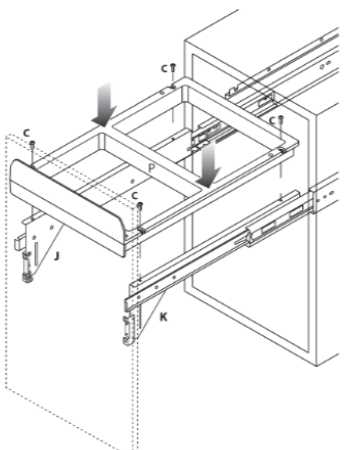

**7** Fit the lid to the lid brackets.

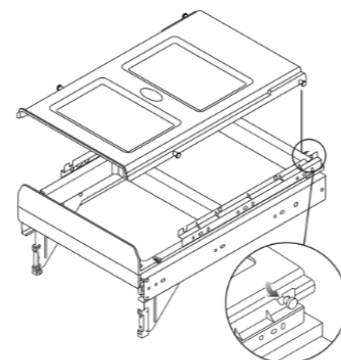

**8** Align the door to the cabinet using the adjustment screws.

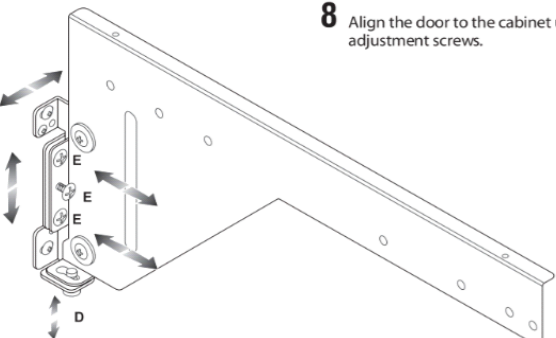

**9** Fit the containers.

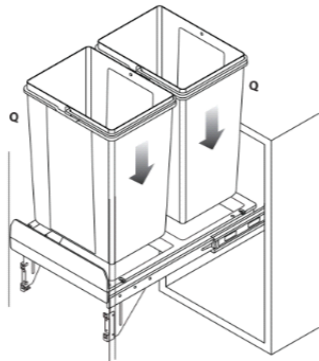

**25 kg** **11L x2**

*IMPORTANT - The unit has a maximum loading limit of 25kg including door.*

**Note.** Adjust Bin Door front after fixing bin vanity to the wall. It is recommended to fit the handles after door adjustment.

# Connex BATHROOM

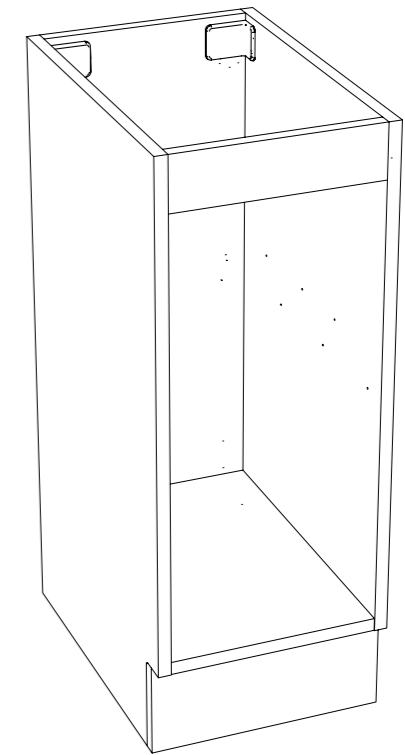

## Floor Vanity with Waste Bin

### Assembly Instructions

Suitable for:

300mm

**Floor Vanity with Waste Bin\***  
(Bin supplied in separate carton)

### Bathroom Panels included.

SIDE PANELS ( 2 )

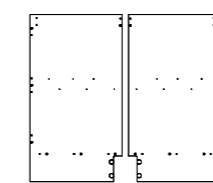

BACK PANEL ( 1 )

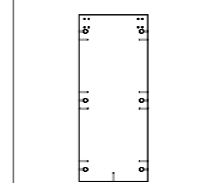

BASE PANEL ( 1 )

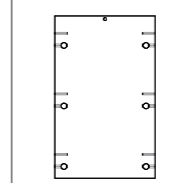

RAIL PANEL ( 1 )



TOE KICK PANEL ( 1 )

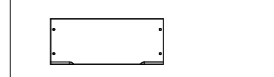

### HAFELE Hardware included.

SCREWS

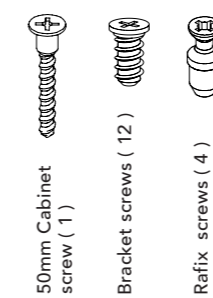

MINIFIX CAMS ( 14 )

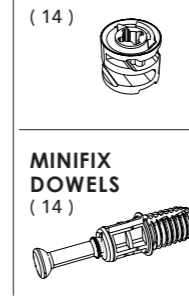

DOWELS ( 16 )



BRACKET & COVER ( 2 ) ( 2 )

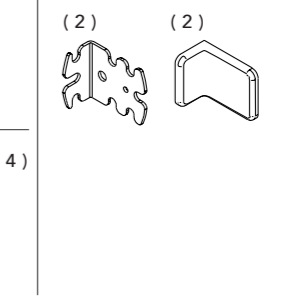

MINIFIX DOWELS ( 14 )

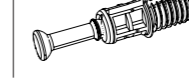

RAFIX SLEEVE ( 4 )

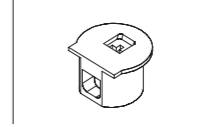

### Required Tools.

POWER DRILL

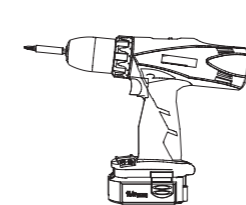

PZ2 BIT

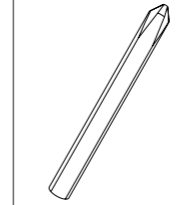

SCREWDRIVER

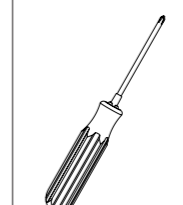

**Handy Note:** Please read the instructions carefully before you start and make sure to identify the parts you need for each step. When assembling it is best to do on a soft surface to prevent damage. **Your Connex 15 Year Home Use Warranty will not apply to incorrectly assembled and/or installed product. Follow the advice of your selected wall fixings (sold separately) to ensure your product is supported once loaded.**



# 1. Insert Hardware into Side Panels.

- a. Lay panels down on a flat surface, insert the dowels and mini fix dowels into the holes.
- b. Insert Rafix Sleeves into pre-drilled holes next to toekick cutout.

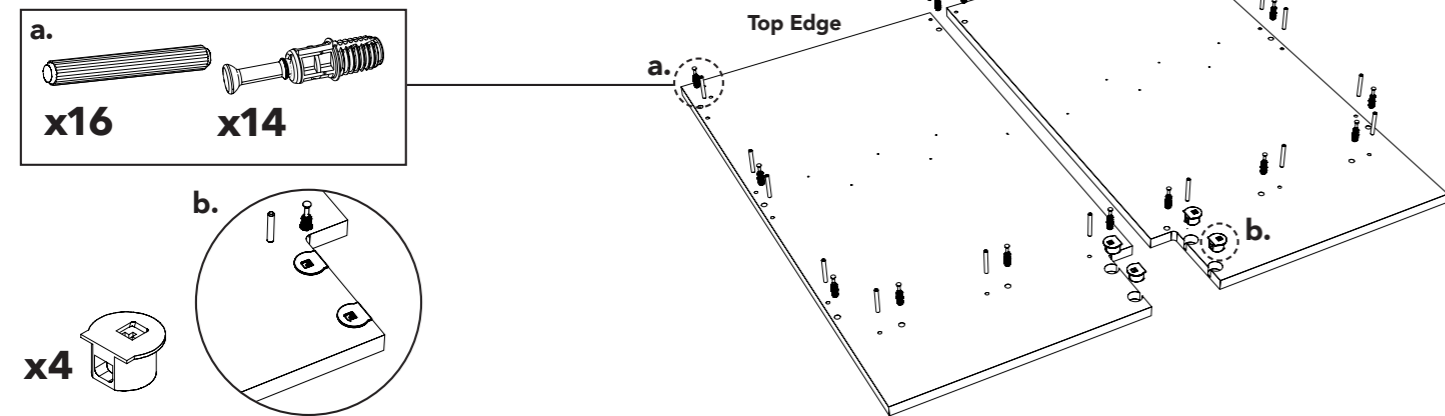

# 2. Fix Back Panel to Side Panels.

- a. Insert the cams into the back panel, with the triangle on the cam pointing towards the adjacent hole.
- b. Fit the back panel to a side panel as shown.
- c. Ensure cams are facing outwards. Lock cams using a screwdriver, turning clockwise.

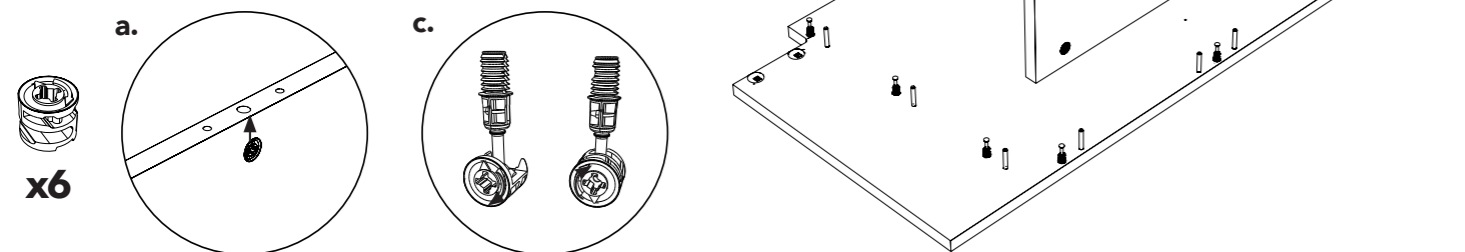

# 3. Fix Base Panel to Side and Back.

- a. Insert the cams into the base panel, with the triangle on the cam pointing towards the adjacent hole. Fit the base panel to a side panel as shown here.
- b. Lock cams using by turning clockwise with a screwdriver, ensure cams face outward.
- c. Fix the base panel to the back panel using supplied cabinet screw.

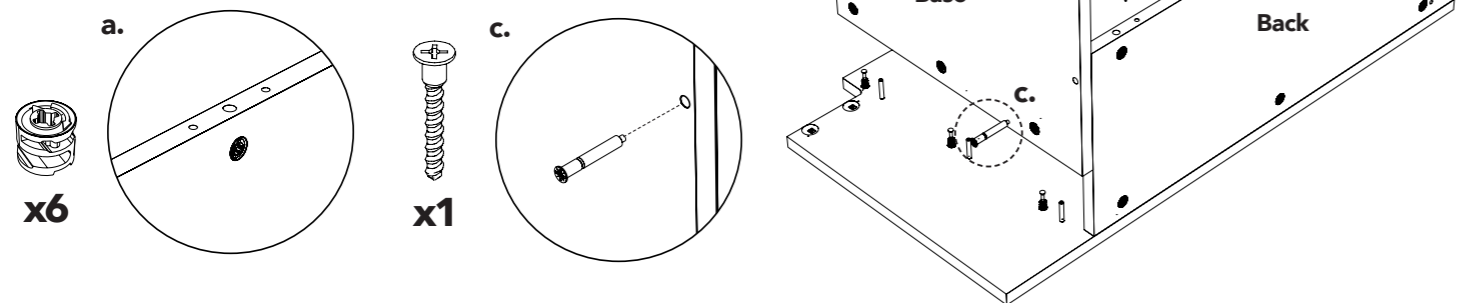

# 4. Fix the Rail onto Side Panel.

- a. Insert the cams into the rail panel, with the triangle on the cam pointing towards the adjacent hole.
- b. Fit the rails to the side panel as shown.
- c. Lock cams using a screwdriver, turning clockwise:

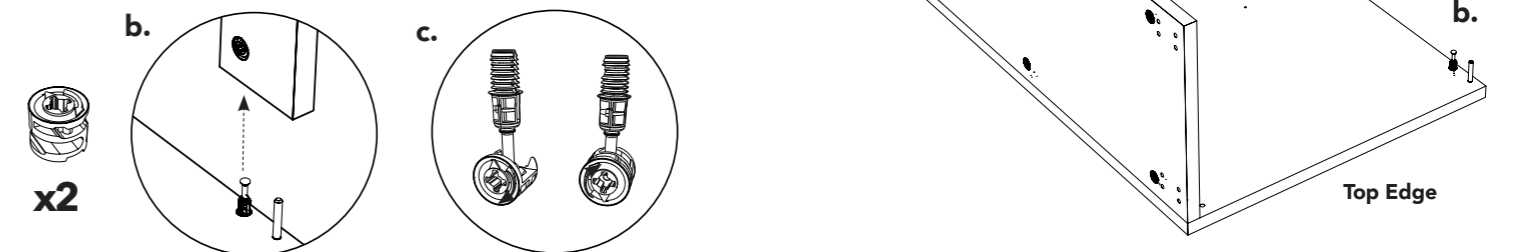

# 5. Fix remaining Side & Toekick Panel.

- a. Align the dowels on the side panel with the back, base and rail panels as shown. Push panels together. Lock all remaining cams using a screwdriver, turning clockwise.
- b. Insert rafix screws into toekick panel. Press toekick onto Rafix sleeves.

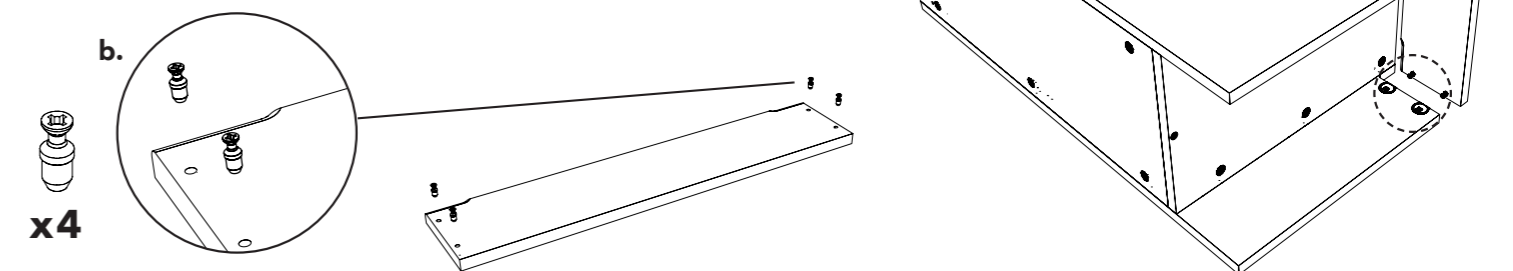

# 6. Fixing the Support Brackets.

- a. Using the supplied screws, fit the support brackets to the back and side panels as shown.

**Tip:** Loosely fasten the lower 2 screws in each side of the back panel to locate the brackets. Then fit the remaining 8 screws in the side and back panels, and tighten all screws.

- b. Press the bracket covers onto the brackets.

