

# buschbeck

MASONRY BBQS | OUTDOOR FIRES



*The Ultimate  
Outdoor Fire, Barbecue  
and Pizza Oven  
....all rolled into one*

**ASSEMBLY INSTRUCTIONS**

## Packaging



Main fireplace package

## Necessary Tools



Cement mortar is supplied. Mix with water to the consistency of toothpaste prior to application.

## Parts

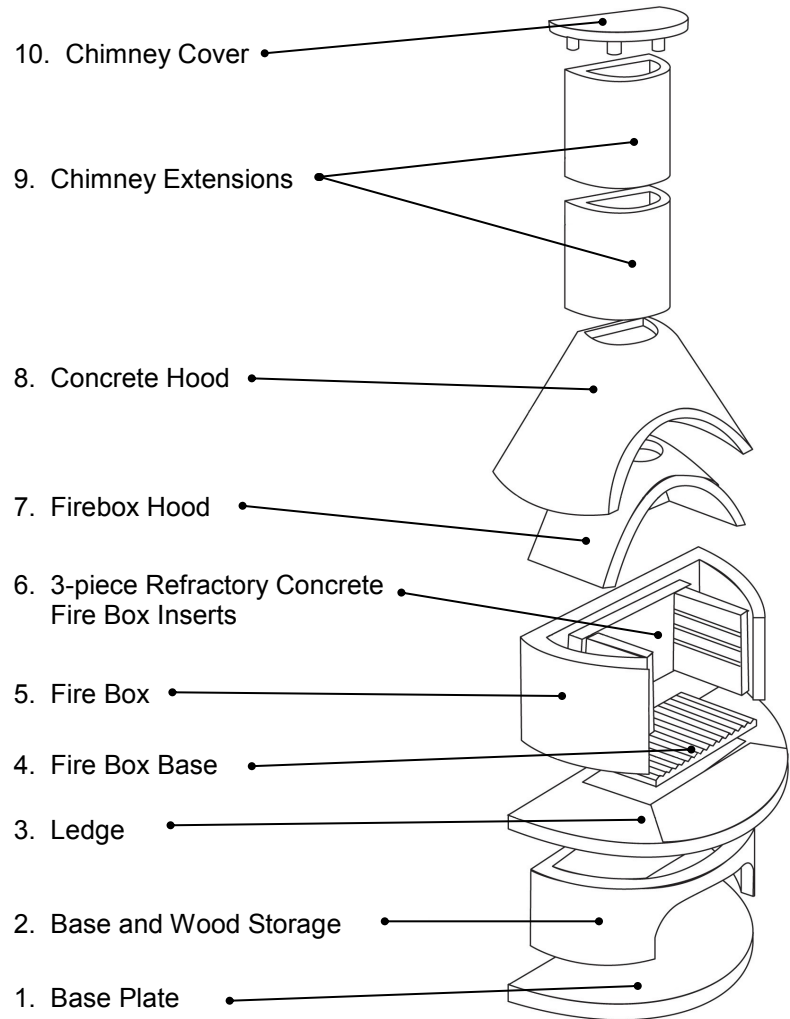

1 Place base on even and firm ground



2 Level base plate



3 Apply mortar on the lower edge of the base and wood storage



4 Mount base and wood storage flush to the back of the base plate



5 Center base and wood storage



6 Apply mortar on the upper edge of the base and wood storage



7 Mount ledge flush to the back of the base and wood storage

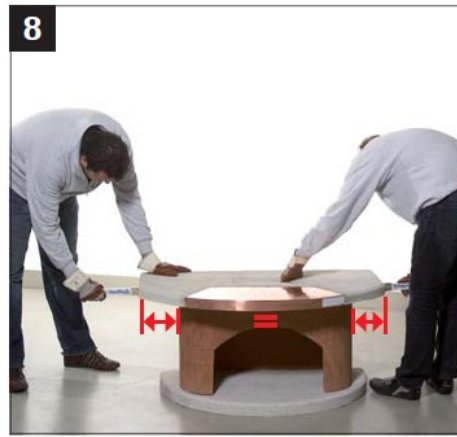

8 Center ledge



9 Apply mortar on the lower edge of the fire box



10 Mount firebox flush to the back of the ledge



11 Center firebox



12 Mount back part of the 3-piece fireproof insert of the firebox. Take care that you have a distance to the firebox of approx. 1/4"



13 Place the side firebox components with the bevel at the front and the grill support slots at the higher levels. Make sure side panels are straight and parallel with each other.



14 Use the chrome cooking grill to measure the correct distance between the firebox side panels.



15 Mount firebox hood. The rear should line up with the inside rear firebox wall.



16 Apply mortar on the upper edge of the firebox



17 Mount concrete hood flush to the back of the firebox



18 Apply mortar on the upper edge of the concrete hood



19 Mount chimney extension



20 Apply mortar on the upper edge of the chimney extension



21 Mount chimney cover



22 Place firebox base



23 For a neater, finished look, use masking tape above and below the seams.

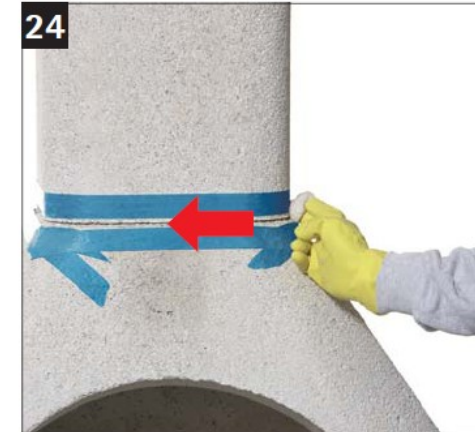

24 Fill the gaps with concrete mortar (supplied).



25 Remove the tape after the mortar sets.



26 Place the heavy duty chrome grill

#### Lighting instructions

It is important to note that concrete products will develop hairline cracks over time due to the nature of the material.

To minimise this with your Buschbeck grill, always start the fire with a small flame to allow the concrete to warm slowly, especially if the fireplace is wet prior to lighting.

If hairline cracks should occur, this is normal and will not affect the function of the fire as all the components are manufactured using steel reinforcing.

The Buschbeck Masonry BBQ is warranted for a period of 2 years from date of purchase. The Warranty covers major structural cracks that occur as a result of a manufacturing defect that prohibit the unit being used for its intended use, but excludes damage caused by excessive heat or overloading (See assembly instructions). Small hairline cracks are considered normal, are non-structural and do not constitute a claim.

Warranty excludes normal wear and tear as would be expected in a masonry cooking device, and is limited to replacement parts and delivery freight only.

Distributed by



#### NEW ZEALAND

11 Kells Place, PO Box 11062, Hamilton 3251, New Zealand  
Ph. +64 7 847 0204 | Fax. +64 7 847 0205  
Email: sales@riverleagroup.co.nz  
[www.riverleagroup.co.nz](http://www.riverleagroup.co.nz)

#### AUSTRALIA

Ph. 1800 839 842 | Fax +64 7 847 0205  
Email. sales@riverleagroup.co.nz  
[www.riverleagroup.com.au](http://www.riverleagroup.com.au)