

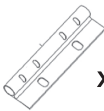





**SKU320105 Instruction Manual**

**Toilet Seat Stability Rail**

**Step 1:** Review all of the parts listed below

|   |   |
|---|---|
|  x 1 | Mounting Bracket                                |
|  x 2 | Angled Tube<br>*Connects Into Mounting Bracket* |
|  x 2 | Side Rail<br>*Connects Into Angled Tube*        |
|  x 2 | Non-Slip Feet<br>*Connects Into Side Rail*      |

**Step 2:** Remove toilet seat from toilet by unscrewing and removing the toilet seat bolts. Set toilet seat and bolts aside, they will need to be screwed back into place after securing the safety rail mounting bracket in place.

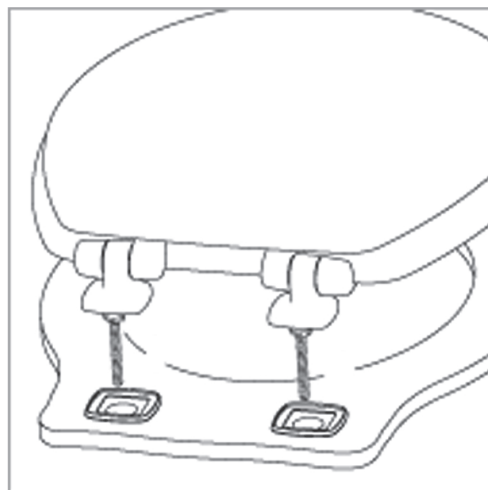

**Step 3:** Place the flat section of the mounting bracket with the holes aligning over the toilet seat holes. Make sure the tube portion of the bracket is aligned like in the image below. With the tube portion closest to the toilet bowl.

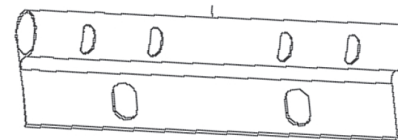

Then place the toilet seat back on, with the toilet seat bolts going through the mounting bracket and screw tightly into place. Now the toilet seat is in place with the mounting bracket secured.

**Step 4:** Attach the two angled tubes into the mounting bracket, like in the image below. The tubes will angle upward. Ensure the buttons "click" into place securely. Choose the hole the button clicks into based on width of stability rail desired. The farthest in provides the greatest level of stability.

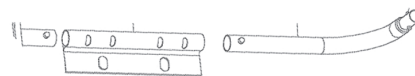

**WARNING:** Before using the rail, please ensure all buttons are secured into place with the buttons showing. Using this safety rail without ensuring these components are secure & stable is dangerous. Use caution when operating. The rail is designed to support 130kgs of weight. Please use both hands for support.

**Step 5:** Attach both side rails into the angled tube, with the padded part of the rail facing upward. Secure the side rail into the tube with the buttons "clicking" into place.

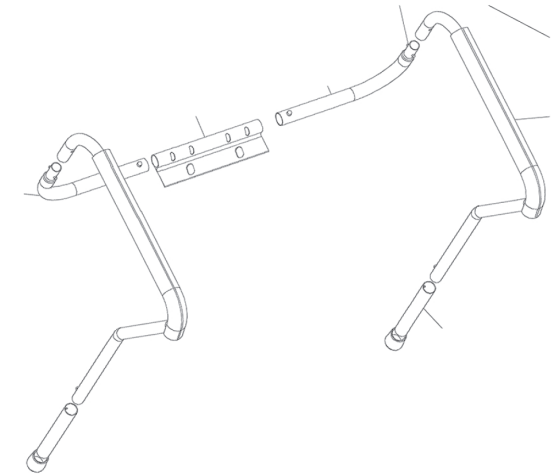

**Step 6:** Finally place the non-slip feet onto the side rail by "clicking" the buttons in place. The feet will rest on the floor and finish the toilet rail.

