

# Technical Data Sheet

# WEISS™

## FV601

1 Room Heat Transfer

with Thermostat

### Dimensions

Cut-out size for inlet fascia 155mm

Cut out size for outlet fascia 155mm

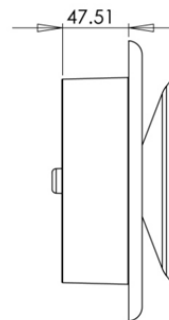
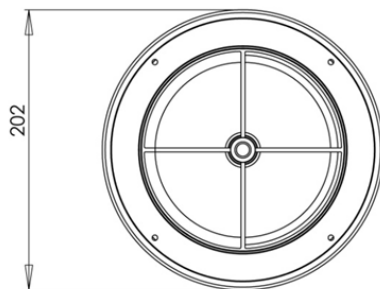
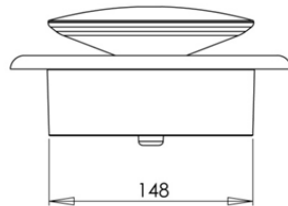
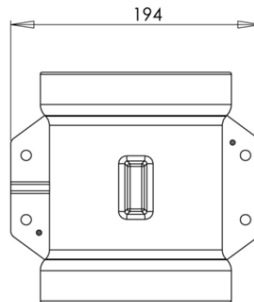
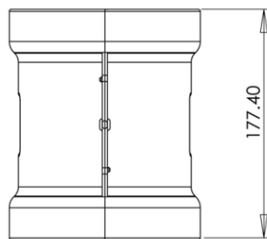
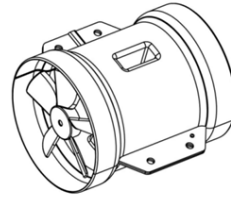
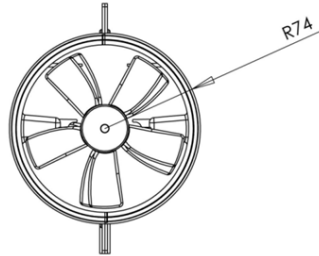

### Specifications

Weight	4.4kg
Colour of front fascia	White
Housing material	FR ABS

### Approval

AS/NZS 603350.2.80:2004 Amdt 1  
AS/NZS 60335.1.2011 incl Amdt.1

### Features

- Easy to install
- 6 metres of 150mm insulated ducting supplied
- Unique 'no fuss' all in one unit
- Digital Thermostat included
- Allows warmth to be moved around your home
- Effective temperature control for your home
- All parts are included
- 3 year extended warranty
- 7 year warranty on the motor

# Technical Data Sheet

## Product Use

The FV601 is used for the transfer of heat

Typical applications:

- Bedrooms
- Lounges
- Living areas

## Environmental Conditions

Operation	to IEC 721-3-3
Climatic conditions	class 3K5
Temperature	0...+50°C
Humidity	<95% r.h.

## Standards

Test standards	AS/NZS 3350.2.80: 1998 Amdts 1-3 "Electrical Fan"
Test Report no EMC Compliance	SD3109 This is a Level One product with an C frame motor that has a very low risk of causing EMC Interference

## General

Free Air Fan Performance	242m <sup>3</sup> / hr 67.2L/sec
Installed decibel rating	42DB

## Ordering

When ordering please give name and type,	
Reference	FV601
Barcode	942000490019-8

## Technical Data

Power Supply	230 VAC
Power consumption	max. 0.75 Amps
Supply Line fusing	max. 10A
For solid wires	2 x 1.5mm <sup>2</sup>
Motor	230-240VAC 50Hz 0.4 Amp
Motor insulation class	B1
Total motor wattage	40 Watts
Motor protection	Thermally protected
Total product wattage	40 watts