

DEWALT®

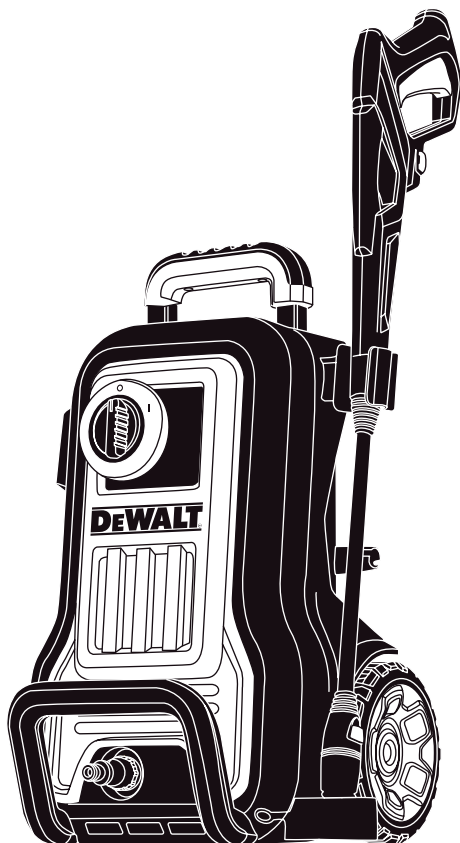

www.DEWALT.com

DXPW140E

PRESSURE WASHER

DXPW140E

Definitions: Safety Guidelines

The definitions below describe the level of severity for each signal word. Please read the manual and pay attention to these symbols.



DANGER: Indicates an imminently hazardous situation which, if not avoided, **will** result in **death or serious injury**.



WARNING: Indicates a potentially hazardous situation which, if not avoided, **could** result in **death or serious injury**.



CAUTION: Indicates a potentially hazardous situation which, if not avoided, **may** result in **minor or moderate injury**.

NOTICE: Indicates a practice **not related to personal injury** which, if not avoided, **may** result in **property damage**.



Denotes risk of electric shock.



Denotes risk of fire.



WARNING: Please read this entire manual before attempting to assemble, operate or install the product.



WARNING: This unit was designed for specific applications. It should not be modified and/or used for any application other than that which it was designed.



NOTICE: Always store your pressure washer in a location where the temperature will not fall below 4 °C. Freeze damage is not covered by the Limited Warranty.

READ AND SAVE THESE INSTRUCTIONS

IMPORTANT SAFETY INSTRUCTIONS



WARNING: When using this product basic precautions should always be followed, including the following:

1. Read all the instructions before using the product.
2. To reduce the risk of injury, do not operate near children or animals.
3. Know how to stop the product and bleed pressures quickly. Be thoroughly familiar with the controls.
4. Stay alert - watch what you are doing.
5. Do not operate the product when fatigued or under the influence of alcohol or drugs.
6. Keep operating area clear of all persons.
7. Do not overreach or stand on unstable support. Keep good footing and balance at all times.
8. Follow the maintenance instructions specified in the manual.
9. Do not touch plug or outlet with wet hands.
10. Avoid accidental starts. Move switch on unit to OFF position before connecting or disconnecting cord to electrical outlets.
11. Water spray must never be directed towards any electric wiring or directly towards the pressure washer machine itself or fatal electric shock may occur.
12. Never carry your pressure washer by the cord. Do not pull on the cord to disconnect from the outlet.
13. To prevent damage, the cord should not be crushed, placed next to sharp objects or near a heat source.
14. Check power cords before using. Damaged cords can reduce performance of pressure washer or cause a fatal electrical shock.
15. The narrow pin point stream is very powerful. It is not recommended for use on painted surfaces, wood surfaces or items attached with an adhesive backing.
16. Keep operating area clear of all persons and animals.
17. Always use both hands when operating pressure washer to maintain complete control of the wand.
18. Do not touch nozzle or water spray while operating. Never place hands in front of nozzle.
19. Wear safety goggles while operating. Wear protective clothing and footwear to protect against accidental spraying.
20. Disconnect power plug from the outlet when not in use and prior to the detaching of the high-pressure hose.
21. Never tie knots or kink the high-pressure hose as damage could result. Inspect the high-pressure hose regularly. Replace the hose immediately if it is damaged, worn or shows any signs of cracks, bubbles, pinholes, or other leakage. Never grasp a high-pressure hose that is leaking or damaged.
22. Do not operate or store this product in temperatures below 4 °C. Freeze damage is not covered by the Limited Warranty.
23. Carefully observe all chemical instructions and warnings before using. Use only approved pressure washer cleaners. Do not use bleach, chlorine, or any cleaners containing acids. Always follow manufacturer's label recommendations for proper use of cleaners. Always protect eyes, skin and respiratory system from cleaners.
24. The pressure washer should not be used in areas where gas vapors may be present. An electric spark could cause an explosion or fire.
25. To minimise the amount of water getting into the pressure washer, the unit should be placed as far as possible from the cleaning site during operation.
26. To prevent accidental discharge, the spray gun should be secured by locking the trigger when not in use.
27. To allow free air circulation, the pressure washer should NOT be covered during operation.
28. Never touch, grasp or attempt to cover a pinhole or similar water leak on the high-pressure hose. The stream of water IS under high-pressure and WILL penetrate skin.

29. Use only hoses and accessories rated for pressure higher than your pressure washer's psi. Never use with any other manufacturer's accessories or components.
30. Never defeat the safety features of this product.
31. Do not operate machine with missing, broken or unauthorised parts.
32. Never spray flammable liquids or use pressure washer in areas containing combustible dust, liquid, or vapors.
33. DO NOT USE EXTENSION CORDS WITH THIS PRODUCT. CONNECT PLUG DIRECTLY TO A DEDICATED INDIVIDUAL BRANCH CIRCUIT. DO NOT PLUG ANY OTHER APPLIANCE IN THE DEDICATED RECEPTACLE WHILE IN USE

 **WARNING:** Risk of injection or injury. Do not direct discharge stream at persons.

 **WARNING:** To reduce the risk of injury or property damage, user must read instruction manual before operating this product.

SAVE THESE INSTRUCTIONS FOR FUTURE USE

 Do not modify the plug provided with the product if it will not fit the outlet installed by a qualified electrician. Do not use any type of adaptor with this product.

 **WARNING:** The appliance may only be connected to an electric supply that has been installed by an electrician in accordance with IEC 60364.

 **WARNING:** The appliance may only be connected to an alternating current. The voltage must correspond with the type plate of the appliance.

 **WARNING:** For safety reasons, we recommend that you operate the appliance only via a residual current device (max. 30mA).

Power Supply and Electrical Info

NOTE: The power supply must be 230V 50Hz and a minimum of 7.3 amps on a dedicated circuit.

- a. Inspect cord before using. Do not use if cord is damaged.
- b. Keep all connections dry and off the ground.
- c. Do not touch plug with wet hands.

If replacement of the plug or cord is needed, use only identical replacement parts. Contact customer service for proper replacement parts.

 **DANGER:** Risk of electric shock. Turn off the appliance and remove the mains plug prior to performing any care and maintenance work. Repair work and work on the electrical components may only be performed by authorised customer service.

SAVE THESE INSTRUCTIONS FUTURE USE

Markings on Tool

The following pictograms are shown on the tool:



Read instruction manual before use.



Wear ear protection.



Wear eye protection.



Double insulated : supplementary insulation is applied to the basic insulation to protect against electric shock in the event of failure of the basic insulation.



Warning symbol: machine not suitable for connection to the potable water mains. The cleaner can only be connected to the water mains if the water mains is separated by a backflow preventer. Make sure that the hose is at least Ø 13mm-1/2 inch and that it is reinforced, 5-25 m.

WARNING: Water that has flown through backflow preventers is considered to be non-potable.

Date Code Position

The date code, which also includes the year of manufacture, is printed into technical data label.

Technical Data

		DXPW140E
Operating Pressure		10 MPa (1450 psi)
Max Pressure		14 MPa (2030 psi)
Water Flow	l/min	4.5
Max Water Flow	l/min	7.5
Max water temp	°C	38
Electrical Requirements	V/Hz	220-240/50
Electrical Cord	m	5 m
High-pressure Hose	m	8 m
Minimum Amp Source	A	7.3
Pressure of Inlet Water		0,14 - 0,7 Mpa (20 - 100 psi)
Inlet Water	°C	cold tap (38 °C max)
Sound pressure level measured	LpA	77 dB
Uncertainty K	KpA	2,5 dB
Arm vibrations		1,5 m/s ²
Uncertainty K		0,5 m/s ²

Pump

The pump was filled with oil at the factory. The pump on this unit is maintenance free and requires no oil.

NOTE: In a continued commitment to improve quality, the manufacturer reserves the right to make component changes, design changes, or specification changes when necessary and without notice.

Assemble Main Unit

NOTICE Depending on the model, the model may be different than shown in the illustrations in these instructions.

1. Wheels
2. Spray gun lower bracket
3. Bumper handle
4. Spray gun upper bracket
5. Spray gun holster
6. Power cord / Nozzle holder
7. Detergent container bracket
8. Foam nozzle with detergent container
9. Handle

Assemble Main Unit

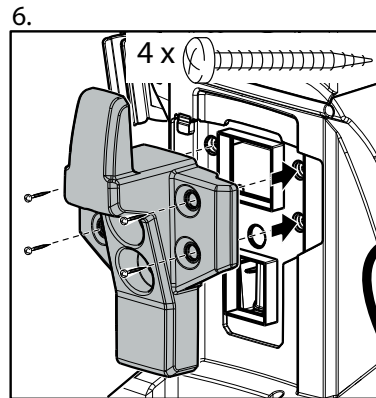
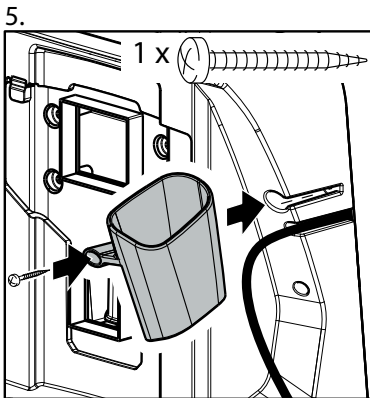
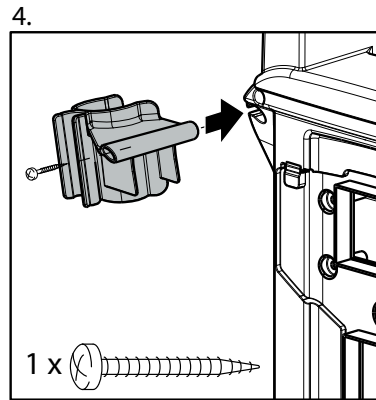
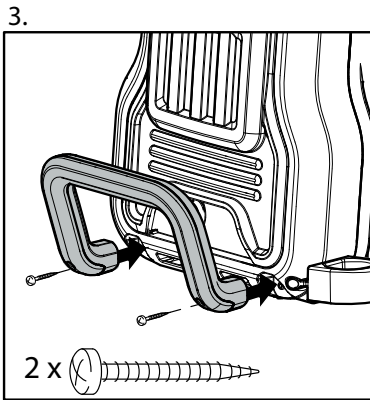
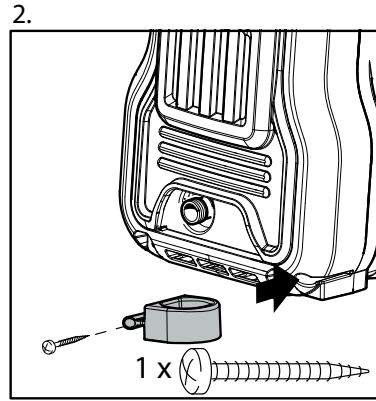
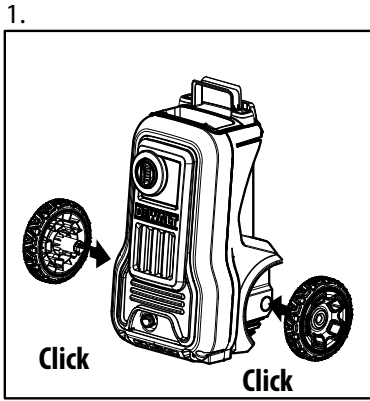

Assemble Main Unit

7.

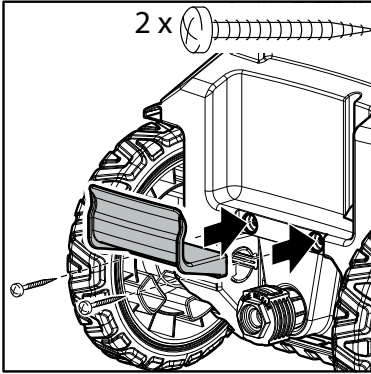

8.

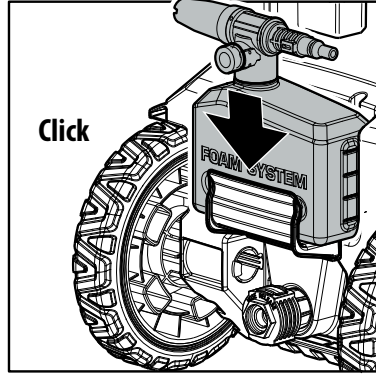

9.

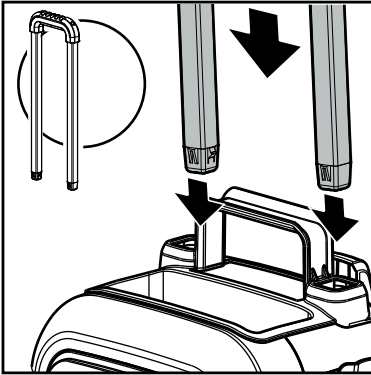

Fig. B

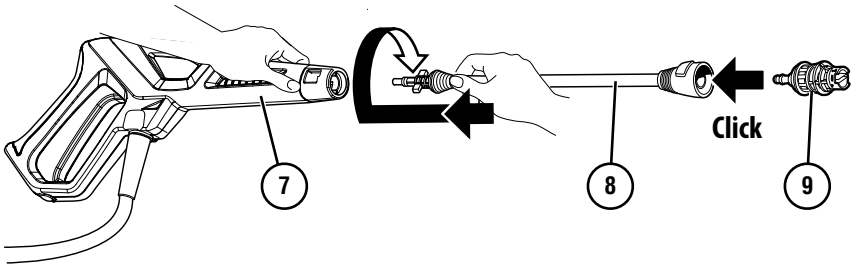
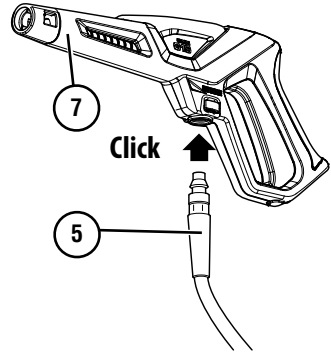
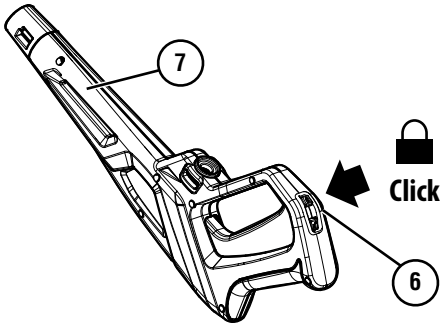

Fig. C

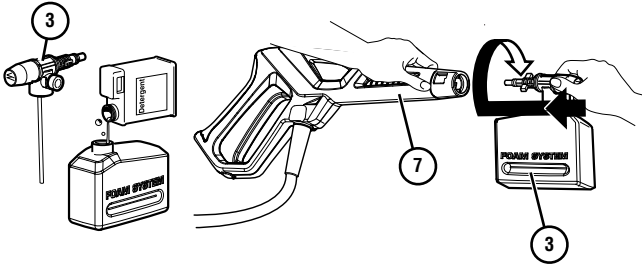

Fig. C-1

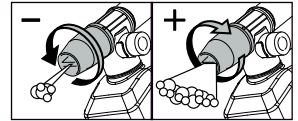

Fig. C-2

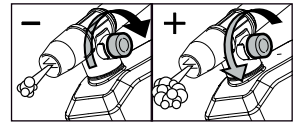
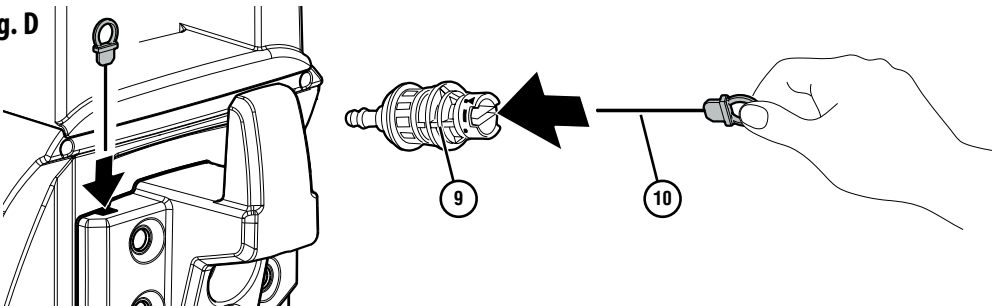

Fig. D



Description (Fig. A)

WARNING: Never modify the pressure washer or any part of it. Damage or personal injury could result.

- 1 Handle assembly
- 2 Power cord / Nozzle holder
- 3 Foam system
- 4 High-pressure water outlet
- 5 High-pressure hose
- 6 Spray gun safety lock
- 7 Spray gun
- 8 Spray wand
- 9 Nozzles (Black , Black Turbo, Green)
- 10 Nozzle cleaning tool
- 11 Water supply inlet
- 12 Garden hose quick connector (filter installed)
- 13 Power cord
- 14 On/Off switch

Intended Use

Your pressure washer has NOT been designed for commercial applications.

The pressure washer can be used for washing surfaces outdoors, whenever pressured water is required to remove dirt.

This pressure washer is a household power tool.

DO NOT let children come into contact with the tool.

Supervision is required when inexperienced operators use this tool.

- **Young children and the infirm.** This appliance is not intended for use by young children or infirm persons without supervision.
- This product is not intended for use by persons (including children) suffering from diminished physical, sensory or mental abilities; lack of experience, knowledge or skills unless they are supervised by a person responsible for their safety. Children should never be left alone with this product.

ASSEMBLY (Fig. B)

DANGER: Risk of injury from spray. Engage the trigger lock **6** when gun is not in use to prevent accidental spraying.

1. Attach high-pressure hose **5** to spray gun **7**. Make sure it is secure.
2. Connect wand **8** to spray gun **7**. Make sure connection is secure.
3. Connect one nozzle **9** to wand **8**.

NOTE: The pump on this unit is maintenance free and requires no oil. If there is a problem with the pump, please contact AUST 1800 841 749 / NZ 0800 467 813 as soon as possible.

OPERATION

Instructions for Use

WARNING: Always observe the safety instructions and applicable regulations.



Pressure Adjustments

The pressure setting is pre-set at the factory to achieve optimum pressure and cleaning. To lower the pressure, follow these instructions.

1. Back away from the surface to be cleaned. The further away you are, the less the pressure will be on the surface to be cleaned.

Spray Wand Nozzles

The nozzles for the spray wand are stored in the nozzle holder **2**. Refer to the following chart to choose the correct nozzle for the job to be performed.

Nozzle Colour	Spray Pattern	Wash	Uses and Surfaces*
Black	Spray pattern variable 	Intense cleaning of unpainted hard surfaces.	Grills, driveways, concrete or brick walkways, unpainted brick or wall putty.
Green	Spray pattern fixed fan 	Standard cleaning nozzle for most applications.	Yard tools, sidewalks, lawn furniture, unpainted siding, medium wash, gutters and eaves, concrete, brick surfaces.
Black Turbo	Spray pattern rotating 	Intense cleaning of unpainted hard surfaces.	Whirls a powerful pin-point jet of water for intense cleaning.

* **NOTICE:** The high-pressure spray from your pressure washer is capable of causing damage to surfaces such as wood, glass, automobile paint, auto stripping and trim, delicate objects such as flowers and shrubs. Before spraying, check the item to be cleaned to assure yourself that it is strong enough to resist damage from the force of spray.

Changing Nozzles on Spray Wand (Fig. B)

DANGER: Risk of injury from spray. Engage the trigger lock **6** when gun is not in use to prevent accidental spraying.

DANGER: Risk of fluid injection. Do not direct discharge stream toward persons, unprotected skin, eyes or any pets or animals. Serious injury will occur.

WARNING: Flying objects could cause risk of serious injury. DO NOT attempt to change nozzles while pressure washer is running. Turn motor off before changing nozzles.

1. Push the button on the spray wand **8** to release the nozzle.
2. Insert other nozzle **9** to end of spray wand **8**.

 **WARNING:** Flying object could cause risk of serious injury. Ensure nozzle is completely inserted in quick-connect socket and quick-connect collar is fully engaged (forward) before squeezing gun trigger.

Chemicals and Cleaning Solvents (Fig. C)

1. Fill the tank of the Foam system **3** with the cleaning solution
2. Connect the Foam system **3** to the spray gun **7**
3. Rotate the head to adjust the width of the fan (Fig. C-1).
4. Turn the knob to adjust the amount of foam (Fig. C-2)

Applying chemicals or cleaning solvents is a low-pressure operation.



NOTE: Use only soaps and chemicals designed for pressure washer use. **Do not use bleach.** Follow all manufacturers instructions.

To Apply Chemicals and Solvents

Cleaning Techniques

When cleaning with the pressure washer, some cleaning tasks can be solved with water alone, but for most tasks it is advantageous to use a detergent. A detergent ensures a quick soaking of the dirt allowing the high-pressure water to penetrate and remove the dirt more effectively.

Application of Detergent

-  **CAUTION:** Avoid working on hot surfaces or in direct sunlight to minimise the chance of the soap damaging painted surfaces.
-  **CAUTION:** Damage may occur to painted surface if soap is allowed to dry on the surface. Wash and rinse a small section at a time.

1. Apply the solution to a DRY work surface.

NOTE: Wetting the surface first is not recommended, as it dilutes the detergent and reduces its cleaning ability.

On a vertical surface, apply soap horizontally from side to side starting from the bottom to avoid streaking.

2. Allow detergent to remain on the surface for a short time before rinsing.
3. Rinse with clean water under high-pressure. On a vertical surface, first rinse from the bottom up, then rinse from the top down. Hold nozzle 15–20 cm from the work surface at a 45° angle using the flat spray as a peeling tool rather than a scrub brush.

NOTE: Ensure that the detergent injection system is completely clean prior to switching from one detergent to another.

Starting

 **WARNING:** To reduce the risk of injury, read the pressure washer instruction manual before starting pressure washer.

 **DANGER:** Risk of fluid injection and laceration. When using the high-pressure setting, **DO NOT** allow the high-pressure spray to come in contact with unprotected skin, eyes, or with any pets or animals. Serious injury will occur.

- Your washer operates at fluid pressures and velocities high enough to penetrate human and animal flesh,

which could result in amputation or other serious injury. Leaks caused by loose fittings or worn or damaged hoses can result in injection injuries. **DO NOT TREAT FLUID INJECTION AS A SIMPLE CUT!** See a physician immediately!

NOTICE: Never pull water supply hose to move pressure washer. This could damage hose and/or pump inlet.

- **DO NOT** use hot water, use cold water only.
- **NEVER** turn water supply off while pressure washer engine is running or damage to pump will result.

Start-up Procedure (Fig. A)

1. Connect the water hose (not included) to the water source. Turn the water source on to remove all air from the hose. When a steady stream of water is present, turn the water source off.
2. Connect the cold water hose to pump inlet by garden hose connector **12**.

NOTE: Water source must provide a minimum of 15 litres per minute (3.9 GPM) at 0,14 Mpa (20 psi).

 **WARNING:** To reduce the possibility of contamination always protect against backflow when connected to a potable water system.

 **WARNING:** According to applicable regulations, the appliance must never be used on the drinking water or without a system separator. Ensure that the connection of your building water installation on which the high-pressure cleaner is operated is equipped with a system separator pursuant to EN 12729 Type BA.

3. Connect high-pressure hose **5** to pump outlet **4**.
4. If applying a chemical or cleaning solution, refer to **Chemicals and Cleaning Solvents**.
5. Turn the water source on.

 **NOTICE:** Risk of property damage. Failure to do so could cause damage to the pump.

6. Remove all air from the pump and high-pressure hose by depressing trigger until a steady stream of water is present.
7. Plug power cord **13** into power receptacle.
8. Place the motor ON/OFF switch **14** to the ON Position.
9. Depress trigger on spray gun **7** to start water flow.

 **WARNING:** Risk of unsafe operation. Stand on a stable surface and grip gun/wand firmly with both hands. Expect the gun to kickback when triggered.

10. Release trigger on spray gun **7** to stop water flow.

 **DANGER:** Risk of injury from spray. Engage the trigger lock **6** when spray gun is not in use to prevent accidental spraying.

11. Adjust spray for the task being performed by changing quick connect nozzle. Refer to **Spray Wand Nozzles**.

Shutting Down

NOTICE: Risk of property damage. Failure to do so could cause damage to the pump.

1. Place the motor ON/OFF switch **14** to the OFF Position.

NOTICE: Risk of property damage. Never turn water supply off while pressure washer is running or damage to pump will result.

2. Turn water source off.
3. Pull trigger on spray gun **7** to relieve any water pressure in hose or spray gun.
4. Remove both the garden hose and high-pressure hose **5** from the unit.
5. Disconnect the spray wand **8** from the spray gun **7**.
6. Turn ON the machine and allow it to run for 5 seconds. (This will clear out most of the water trapped in the pump).
7. Unplug machine.
8. Refer to **Storage** for proper storage procedures.

Automatic Total Stop®

NOTICE: Automatic Total Stop, which stops the machine during the bypass phase.

To start the water cleaner, it is therefore necessary to set the switch on position (I) "ON"; after that press the pistol trigger: the Total Stop will start the machine and will stop it automatically when the trigger is released. It is advisable to put on the safety of the pistol trigger whenever the machine is stopped, in order to avoid unintentional starting.

- Any automatic start of the machine without pressing the gun trigger is attributable to air bubbles in the water or other similar phenomena which do not imply the existence of any defects in the machine.

- Do not leave the appliance unattended during the standby for more than 5 minutes. Contrarily, for the safety of the appliance it is necessary to re-turn the switch into the (0) OFF position.

MAINTENANCE



WARNING: Risk of injury. When performing maintenance, you may be exposed to hot surfaces, water pressure or moving parts that can cause serious injury or death.

To ensure efficient operation and longer life of your pressure washer, a routine maintenance schedule should be prepared and followed. If the pressure washer is used in unusual conditions, such as high temperatures or dusty conditions, more frequent maintenance checks will be required.

Pump

The pump was filled with oil at the factory. The pump on this unit is maintenance free and requires no oil to be added by the user. If there is a problem with the pump, please contact:

AUST 1800 841 749 / NZ 0800 467 813.

O-Ring Maintenance

1. The use of lubricant (petroleum or synthetic grease) helps seat o-rings providing an improved seal. Apply lubricant

to o-rings prior to assembling high-pressure hose (pump end) , high-pressure hose (gun end) , garden hose to the pump , and plastic wand (gun end). Purchase an O-Ring Maintenance Kit by contacting

2. Remove all debris, especially from the ventilation slots.

Nozzle Cleaning (Fig. D)

If the nozzle becomes clogged with foreign materials, such as dirt, excessive pressure may develop. If the nozzle becomes partially clogged or restricted, the pump pressure will pulsate. Clean the nozzle immediately using the nozzle kit supplied and the following instructions:

1. Shut off the pressure washer and turn off the water supply.
2. Pull trigger on spray gun **7** handle to relieve any water pressure.
3. Disconnect the spray wand **8** from the gun **7**.
4. Remove the nozzle from the spray wand **8**. Remove any obstructions with the nozzle cleaning tool **10** provided and back flush with clean water.
5. Direct water supply into nozzle **9** to back flush loosened particles for 30 seconds.
6. Reassemble the nozzle **9** to the spray wand **8**.
7. Reconnect spray wand **8** to gun **7** then turn on water supply.
8. Start pressure washer and place spray wand **8** into high-pressure setting to test.

To Clean the Water Inlet Filter

This filter screen **12** should be checked periodically and cleaned if necessary.

1. Clean filter by flushing it with water on both sides.

NOTE: Do not operate pressure washer without filter properly installed.

STORAGE

Pressure Washer

1. Drain all water from high-pressure hose **5**.
2. With nozzle **9** pointed down and the spray gun **7** and wand **8** in a vertical position, squeeze trigger to drain all water from spray gun and wand. Store in gun holder.
3. Store the machine and accessories in a dry, climate controlled environment. Do not store the machine or accessories in a place where the temperature could drop below 4 °C.



CAUTION: Risk of personal injury. Avoid placing hands between handle and frame when assembling to prevent pinching.



NOTICE: Risk of property damage. Always store and transport unit in an upright position.

ACCESSORIES



WARNING: *Since accessories, other than those offered by DeWALT, have not been tested with this product, use of such accessories with this tool could be hazardous. To reduce the risk of injury, only DeWALT recommended accessories should be used with this product.*

Consult your dealer for further information on the appropriate accessories. If you need assistance in locating any accessory for your tool, please contact the FNA Group at AUST 1800 841 749 / NZ 0800 467 813.



DANGER: *Risk of fluid injection. When using replacement lances or guns with this pressure washer, do not use a lance and/or lance/gun combination that is shorter in length than what was provided with this pressure washer as measured from the nozzle end of the lance to the gun trigger.*



WARNING: *The use of any other accessory not recommended for use with this tool could be hazardous. Use only accessories rated equal to or higher than the rating of the pressure washer.*

Protecting the Environment



Separate collection. Products and batteries marked with this symbol must not be disposed of with normal household waste.

Products and batteries contain materials that can be recovered or recycled reducing the demand for raw materials. Please recycle electrical products and batteries according to local provisions. Further information is available at www.2helpU.com.

Service Information

Please have the following information available for all service calls:

Model Number:	see technical data label
Serial Number:	see technical data label
Date and Place of Purchase:	see proof of purchase

Repairs

To assure product SAFETY and RELIABILITY, repairs, maintenance and adjustment should be performed by a FNA factory service centre, a FNA authorised service centre or other qualified service personnel. Always use identical replacement parts.

Glossary

Bypass mode: Allows water to re-circulate within pump when the gun trigger is not pulled.

CU: Cleaning Units. GPM multiplied by psi. (GPM x PSI = CU)

LPM: Litres Per Minute. The unit of measure for the flow rate of water.

PSI: Pounds per Square Inch. The unit of measure for water pressure. Also used for air pressure, hydraulic pressure, etc.

kPa (kilopascal): Metric pressure measurement. 1 kilopascal equal 1000 pascals.

Quick-connect spray wand: Allows the user to quickly change out high-pressure nozzles. Refer to **Spray Wand Nozzles**.

Water supply: All pressure washers must have a source of water.

Limited Warranty

The manufacturer of this product agrees to repair or replace designated parts that prove defective within the warranty periods below. Specific limitations/extensions and exclusions apply. These warranties pass through to the end user and are non-transferable.

This warranty covers defects in material and workmanship. To the extent permitted by law, the manufacturer's warranty obligations under this warranty are limited to the repair and replacement of defective products as provided herein. It does not cover machines used for rental purposes, commercial purposes or commercial applications. It does not extend to normal wear and tear of moving parts or to components affected by moving parts. Normal wear and tear items include, but are not limited to, valves and seals, which are therefore not covered by this warranty. It does not extend to loss, damages or expenses which are outside of the control of the manufacturer – including damages from shipping (claims must be filed with freighter), accident, failure to properly maintain or store the product, usage of water of poor quality, abuse, freezing, chemical deterioration, scale build up, rust, corrosion, thermal expansion, acts of God, misuse, or neglect. To the extent permitted by law, it does not extend to damage from repairs using parts not purchased from the manufacturer or to alterations performed by non-factory Authorised personnel. Failure to install and operate equipment according to the guidelines put forth in the instruction manual shall void the Limited Warranty.

To the extent permitted by law, the manufacturer will not be liable to any persons for consequential damage, for personal injury, or for commercial loss.

Warranty Periods under the Limited Warranty:

MOTOR / PUMP (Defects in material and workmanship)

Three (3) Years from date of purchase

OTHER COMPONENTS (Defects in material and workmanship)

Includes nozzles, hoses, spray guns, wands, tires, feet

Ninety (90) Days from date of purchase

Limited Warranty

The benefits provided by this Limited Warranty are in addition to other rights and remedies of the consumer at law in relation to the goods or services to which this Limited Warranty relates.

Our products come with guarantees that cannot be excluded under either:

- 1) The Consumer Guarantees Act; or
- 2) Australian Consumer Law

Where the purchaser of this product is in New Zealand and is a “Consumer” under the Consumer Guarantees Act 1993 (NZ), the warranty provisions herein are to be read in addition and subject to the Consumer Guarantees Act 1993 unless excluded in accordance with that Act. In New Zealand, you are entitled to repair or replacement, or damages for any reduction in the value of the goods resulting from any failure to meet the guarantees in that Act and for any other reasonably foreseeable loss or damage arising.

Where the purchaser of this product is in Australia and is a consumer under Australian Consumer Law, the warranty provisions herein are to be read in addition and subject to Australian Consumer Law unless excluded in accordance with that Law. In Australia, you are entitled to a replacement or refund for a major failure and for compensation for any reasonably foreseeable loss or damage. You are also entitled to have the goods repaired or replaced if the good fail to be of acceptable quality and the failure does not amount to a major failure.

The manufacturer will honour the terms of all component warranties and satisfy claims of the appropriate warranty provisions through a network of factory Authorised and trained Warranty Service Centres. To make a claim under the terms of the Limited Warranty, all parts said to be defective must be retained and available for return upon request to a designated Warranty Service Centre for warranty inspection. The judgments and decisions of the manufacturer concerning the validity of warranty claims, under the Limited Warranty, are final.

Any product subject to a warranty claim-- please call the phone numbers listed below for specific warranty instructions, procedures, and information regarding the Warranty Service Centres. You must present proof of purchase when making a warranty claim.

Australia Phone : 1800 841 749

New Zealand Phone : 0800 467 813

FNA Group, Inc. / Mayo Hardware PTY LTD

4 Secombe Place Moorebank NSW 2170 Australia

Troubleshooting Guide

This section provides a list of the more frequently encountered malfunctions, their causes and corrective actions. The operator or maintenance personnel can perform some corrective actions, and others may require the assistance of an authorised technician.

TROUBLESHOOTING CODES

PROBLEM	CODE	POSSIBLE CAUSE	POSSIBLE SOLUTION
Motor will not start when switched ON	1	ON/OFF switch in OFF position.	Place ON/OFF switch in ON position.
When unit is switched ON, the motor hums but does not turn on	2	The main voltage is insufficient, lower than the minimum required.	Check that the main power supply is adequate.
	3	Extension cord is too long or wire gauge is too small.	We do not recommend the use of extension cords with your pressure washer. If you must use an extension cord, verify that it meets the minimum requirements listed in the Extension Cord paragraph under the Power Supply & Electrical Info in this manual.
No or low pressure (initial use) Pump Pulsates	4	Spray wand not in high-pressure.	See Spray Wand Nozzles under Operation .
	5	Low water supply.	Water supply must be at least 15 liters per minute (3.9 GPM) and 0,14 Mpa (20 psi).
	6	Leak at high-pressure hose fitting.	Replace hose.
	7	Nozzle obstructed.	See Nozzle Cleaning under Maintenance .
	8	Water filter screen clogged.	Remove and clean filter.
	9	Air in hose.	Turn off the washer, then the water source. Disconnect the water source from the pump inlet and turn the water source on to remove all air from the hose. When there is a steady stream of water present, turn water source off. Reconnect water source to pump inlet and turn on water source. Squeeze trigger to remove remaining air.
Will not draw chemicals	10	Chemical too thick.	Dilute chemical. Chemical should be the same consistency as water.
No or low pressure (after period of normal use)	11	Damaged pump.	Have replaced by an authorised service centre.
Water leaking at gun/spray wand connection	12	Worn or broken o-ring.	Check and replace.
	13	Loose hose connection.	Tighten.
Water leaking at pump	14	Loose connections.	Check and tighten all connections.

ACCESSORIES



NOTICE: *The use of any other accessory not recommended for use with this tool could be hazardous. Use only accessories rated equal to or greater than the rating of the pressure washer.*



NOTICE: SERVICE INFORMATION. *Do not return this product to your retailer. Please contact our customer service department.*



DANGER: *Never modify or alter this product. Alterations or modifications may invalidate the warranty and may cause serious injury or death. To the extent permitted by law, the Manufacturer will not be liable to the user for damage, injury, or death resulting from alterations or modifications made to this product.*

FNA Group, Inc. 7152 99th Street, Pleasant Prairie WI 53158

The following are trademarks for one or more DEWALT power tools: the yellow and black color scheme; the "D" shaped air intake grill; the array of pyramids on the handgrip; the kit box configuration; and the array of lozenge-shaped humps on the surface of the tool.

DEWALT®, GUARANTEED TOUGH®, and the yellow and black color scheme are trademarks of the DEWALT Industrial Tool Co., used under license.

Copyright © 2019

SIMPSON®, AUTOMATIC TOTAL STOP®, and POWERWASHER™ are trademarks of FNA Group, Inc.

MADE IN P.R.C.

Copyright DEWALT